

NOTE
PLAT OF MONCEAUX
IS CODED 24 IN
43-43-33

- N1/2 01 EL CID PARK
 - 02 ALMERIA
 - 03 LAFAYETTE PARK
 - 04 PLAT OF EL CID COURT
 - 05 PROSPECT PARK SOUTH
 - 06 RESUB OF LOTS 9 & 10 BLK A & LOTS 10, 11 & 12 BLK D OF PROSPECT PARK SOUTH
 - 07 RESUB OF BLKS 6 & H
 - N1/2 08 RESUB OF LOTS 9-14 BLK N & LOTS 8-15 BLK O OF PROSPECT SOUTH
 - S1/2 09 SOUTHLAND PARK
 - 10 REV. PL OF BLKS 12-14 OF SOUTHLAND PARK
 - 11 WENONAH PLACE
 - 12 ADD. 2 TO ESTATES OF SOUTH P. B.
 - 13 CENTRAL PARK ADD. 1
 - 14 CENTRAL PARK SOUTH PALM BEACH
 - S1/2 15 ADD. 1 TO ESTATES OF SO. PALM BCH.
 - N1/2 16 PLAT OF McGAUGHEY TRACT
 - S1/2 17 TULIP SUB
 - S1/2 18 PORTOFINO SOUTH CONDO
 - S1/2 19 SOUTHERIDGE CONDO (1982)
 - S1/2 20 FLAGLER YACHT CLUB CONDO (1982)
 - S1/2 21 FLAGLER HOUSE COND (1985)
 - S 1/2 22 HARBOR TOWERS AND MARINA COND (1987)
 - SW 23 WENONAH PLACE TWHMS (89) PB60P152
 - SW 24 MARINA AT HARBOR TOWERS COND (93)
- PB11 - PG 7
 - PB9 - PG79
 - PB9 - PG17
 - PB18 - PG45
 - PB 7 - PG59, 60, & 66
 - PB 9 - PG80
 - PB 8 - PG60
 - PB9 - PG21
 - PB9 - PG18
 - PB10 - PG43
 - PB12 - PG67
 - PB 8 - PG4
 - PB 9 - PG8
 - PB 8 - PG71
 - PB 7 - PG73
 - PB24 - PG72
 - PB28 - PG23

NOTE:
ALL OF SECTION 34 IS IN
THE MUNICIPALITY OF WEST
PALM BEACH CODED 74

L A K E
W O R T H

P A L M
B E A C H

NOTE: (2&1)
WEST 3' OF
LOT 23 OF
SUB 14

NOTE: SOUTH PALM BEACH ESTS. REPL.
PB7 P33 IS CODED 74-43-44-03-01

FOR REMAINDER OF
PARCEL SEE 3-44-43

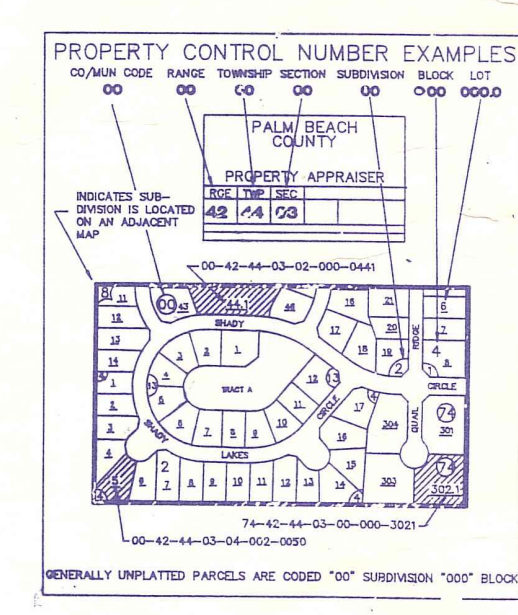

NOTE:
NOT TO BE REPRODUCED IN
ANY FORM EXCEPT BY EXPRESS
WRITTEN CONSENT FROM THE
PALM BEACH COUNTY
PROPERTY APPRAISER
Information shown hereon is
compiled from the best available
sources and CANNOT be used
for surveys or land transfers of
any type.

PALM BEACH COUNTY
GARY R. NIKOLITS
PROPERTY APPRAISER

RGE	TWP	SEC	AERIAL
43	43	34	NO 69 35
SCALE		1"=200'	
DRAWN BY		ED KESHIAN	
UPDATED			

36	31	32	33	34	35	36	31
1	6	8	4	3	2	1	6
12	7	8	9	10	11	12	7
13	16	17	16	15	14	13	16
24	19	20	21	22	23	24	19
25	30	29	28	27	26	25	30
36	31	32	33	34	35	36	31
1	6	8	4	3	2	1	6