

Palm Beach County (County) makes no representation or warranties whatsoever on the attached / enclosed information reflected herein pertaining to easements, rights-of-way, setback lines, reservations, agreements, and other similar matters. The information provided herein should not be relied upon by the requesting party to confirm the existence / non-existence of facts contained herein.

- NE 01 FRENCHMAN'S CREEK PL 2 (1979) PB 35-71
- 02 FRENCHMAN'S CREEK PL NO 6 (1983) PB 44P133
- NE 03 FRENCHMAN'S CREEK PL 2 REPL (P) PB 54P42
- NE 04 FRENCHMAN'S CREEK PAR D (87) PB 55P40
- NW 05 FRENCHMAN'S CREEK PAR G-4 (87) PB 55P87
- NW 06 FRENCHMAN'S CREEK PAR G-2 (89) PB 55P119
- NW 07 FRENCHMAN'S CREEK PAR G-3 (89) PB 55P126
- N 1/2 08 FRENCHMAN'S CREEK PL 1 REPL (88) PB 56P40
- NW 09 FRENCHMAN'S CREEK PAR G-1 (88) PB 57P66
- SE 10 FRENCHMAN'S CREEK PAR E-2 (88) PB 58P157
- SE 11 FRENCHMAN'S CREEK PAR E-1 (88) PB 58P161
- SW 12 FRENCHMAN'S CREEK PAR E-5 (89) PB 59P96
- SW 13 FRENCHMAN'S CREEK PAR E-4 (89) PB 59P100
- SW 14 FRENCHMAN'S CREEK PAR E-3 (89) PB 59P103
- SW 15 FRENCHMAN'S CREEK PAR F-1 (89) PB 59P120
- SW 16 FRENCHMAN'S CREEK PAR F-2 (89) PB 59P123
- SW 17 FRENCHMAN'S CREEK PAR F-3 (89) PB 60P108
- NW 18 FRENCHMAN'S CREEK PAR G-1 REPL (89) PB 61P56
- NE 19 FRENCHMAN'S CREEK PAR A-2 (90) PB 63P4
- NE 20 FRENCHMAN'S CREEK REPL PAR A2 (91) PB 65P91
- ALL 21 FRENCHMAN'S CREEK GOLF COURSE (91) PB 67 P101

ALL CODED (52)

NOTE:
NOT TO BE REPRODUCED IN ANY FORM EXCEPT BY EXPRESS WRITTEN CONSENT FROM THE PALM BEACH COUNTY PROPERTY APPRAISER

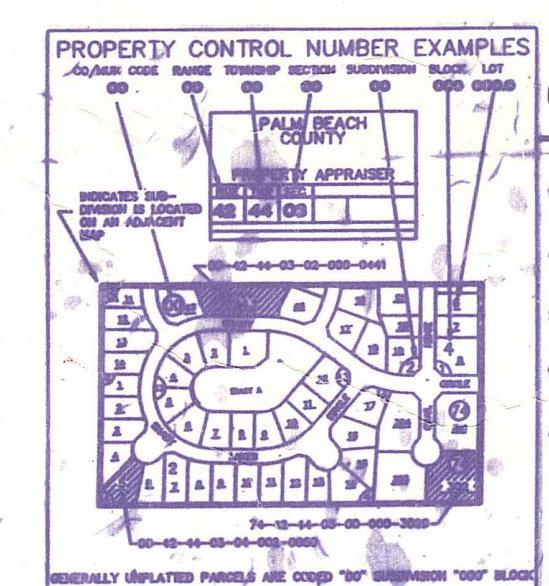

Information shown hereon is compiled from the best available sources and CANNOT be used for surveys or land transfers of any type.

PALM BEACH COUNTY
N-10
PROPERTY APPRAISER

RG	TWP	SEC	AERIAL
43	41	30	NO
SCALE			
DRAWN BY			
UPDATED			

RAILROAD
AIR
ROAD
EAST
FLORIDA
STATE

35.94
96.87
36.00
37.00
38.00
39.00
40.00
41.00
42.00
43.00
44.00
45.00
46.00
47.00
48.00
49.00
50.00
51.00
52.00
53.00
54.00
55.00
56.00
57.00
58.00
59.00
60.00
61.00
62.00
63.00
64.00
65.00
66.00
67.00
68.00
69.00
70.00
71.00
72.00
73.00
74.00
75.00
76.00
77.00
78.00
79.00
80.00
81.00
82.00
83.00
84.00
85.00
86.00
87.00
88.00
89.00
90.00
91.00
92.00
93.00
94.00
95.00
96.00
97.00
98.00
99.00
100.00

66' area by D. 778-440 ABANDONED. SEE SECT. 21 FOR ABANDONED RW.

66' area of road center
82'-16" dedicated
D. 778-440 P.B. 58-157