

Palm Beach County (County) makes no representation or warranties whatsoever on the attached / enclosed information reflected herein pertaining to easements, rights-of-way, setback lines, reservations, agreements, and other similar matters. The information provided herein should not be relied upon by the requesting party to confirm the existence / non-existence of facts contained herein.

WEST PENINSULAR TITLE COMPANY
 VS. PALM BEACH COUNTY; SEE
 OR 5608-1986, ATTACHED TO
 PALM BEACH FARMS CO. PL. N'S
 MAP, FOR RD R/W IN BLK 75.

Brentwood of Boca
 PHASE 1
 TRACT 101 OF
 BLK 75 (SW COR)
 DRAINAGE EZNTS
 B3935-342 & 343
 &
 UTILITY EZNNT
 B3935-344
 Detailed map attached

NOTE:
 NOT TO BE REPRODUCED IN
 ANY FORM EXCEPT BY EXPRESS
 WRITTEN CONSENT FROM THE
 PALM BEACH COUNTY TAX
 ASSESSOR.
 Information shown hereon is
 compiled from the best available
 sources and CANNOT be used
 for surveys or land transfers of
 any type.

PALM BEACH COUNTY		
SEC. 8	5.49	
BLOCK 75	TWP. 47	RGE. 42
1" = 200' N. 179 D.		

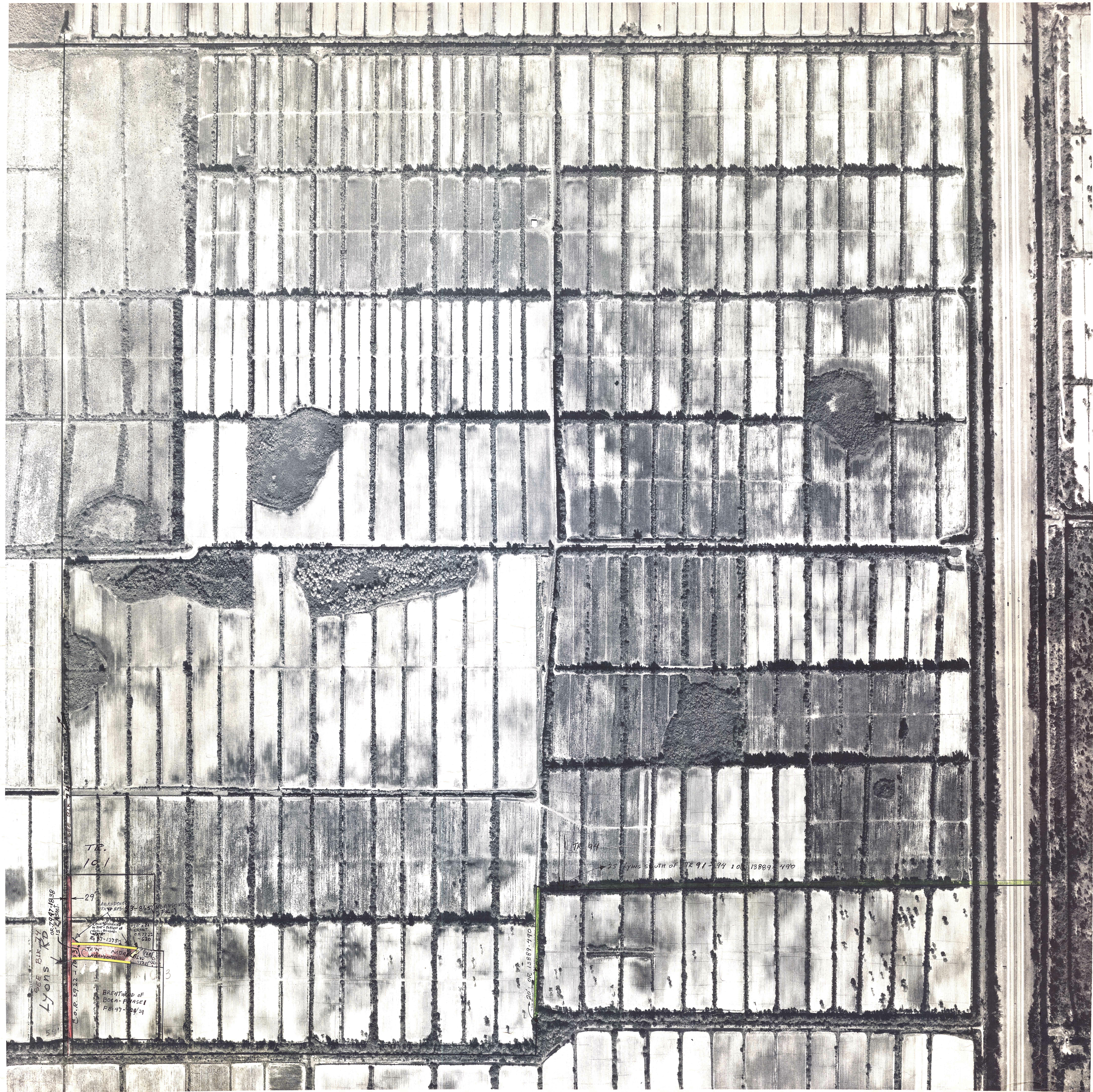

TR. 101

TR. 94

25' lying south of TR 91-94 101 13889-490

29
 ABANDONED
 TR. RES. 9-865 (Palm Beach County)

20' x 21'
 26' x 21'
 26' x 21'
 26' x 21'
 26' x 21'
 26' x 21'

Brentwood of Boca - Phase 1
 P.B. 47-28/29

SEE BIRLEY
 LYONS
 12/27/1988

MOCK ROOSE & SEARCY
 Consulting Engineers

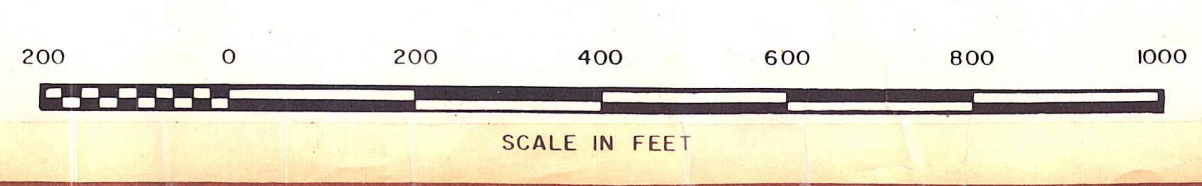

Aerial Photo Date — FEB. 14, 1968