

Palm Beach County (County) makes no representation or warranties whatsoever on the attached / enclosed information reflected herein pertaining to easements, rights-of-way, setback lines, reservations, agreements, and other similar matters. The information provided herein should not be relied upon by the requesting party to confirm the existence / non-existence of facts contained herein.

Notes:
 A portion of Haverhill Rd. is posted & viewed as per C.M.B dated 10-7-1925.

NOTE:
 PT OF SEC IN COUNTY (00)
 PT OF SEC IN WPB (74)

NOTE:
 NOT TO BE REPRODUCED IN ANY FORM EXCEPT BY EXPRESS WRITTEN CONSENT FROM THE PALM BEACH COUNTY ASSESSOR.
 Information shown hereon is compiled from the best available sources and CANNOT be used for surveys or land transfers of any type.

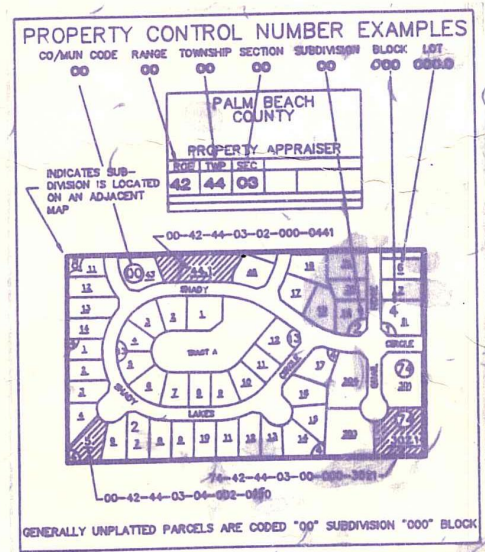

PALM BEACH COUNTY
N-14
PROPERTY APPRAISER

RGE	TWP	SEC	AERIAL
42	42	35	NO 2054
SCALE			1" = 200'
DRAWN BY			Joa Rush
UPDATED			4/1/92 gms

G-14