

NE 01 RADERS SUB NO 2 FB20P34

**Palm Beach County (County) makes no representation or warranties whatsoever on the attached / enclosed information reflected herein pertaining to easements, rights-of-way, setback lines, reservations, agreements, and other similar matters. The information provided herein should not be relied upon by the requesting party to confirm the existence / non-existence of facts contained herein.**

NOTE:

PART OF SEC CODED IN 00 & 04

W/ of S/D #2 RADERVILLE PB 20-34

| O. R. #   | PARCEL | LOT | BLK |
|-----------|--------|-----|-----|
| 3878-1288 | 35A    | 22  | 1   |
| 3878-1292 | 35C    | 21  | 1   |
| 3878-1290 | 35B    | 1   | 2   |
| 3809-1886 | 19B    | 27  | 2   |
| 3809-1888 | 19A    | 1   | 3   |
| 3809-1890 | 2A     | 27  | 3   |
| 3809-1892 | 2B     | 21  | 4   |
| 3809-1894 | 2C     | 49  | 4   |
| 3809-1896 | 9      | 1   | 4   |
| 3814-1285 | 10     | 28  | 3   |
| 3819-463  | 18     | 54  | 3   |
| 3819-465  | 33     | 49  | 2   |
| 3819-467  | 20     | 28  | 2   |
| 3819-469  | 20     | 28  | 2   |

**NOTES**  
 RADERVILLE SUB. N° 2. PB. 20-34.  
 RES. 86-696 ACCEPTING PLATTED RD. AS COUNTY MAINTAINED RD'S.  
 NOT S Street

NOTE:  
 NOT TO BE REPRODUCED IN ANY FORM EXCEPT BY EXPRESS WRITTEN CONSENT FROM THE PALM BEACH COUNTY ASSESSOR.

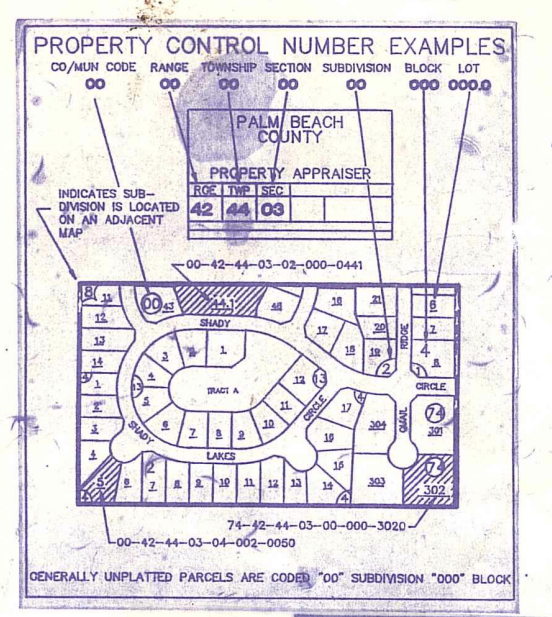

Information shown hereon is compiled from the best available sources and CANNOT be used for surveys or land transfers of any type.

**PALM BEACH COUNTY**  
**GARY R. NIKOLITS**  
 PROPERTY APPRAISER

|                         |    |        |        |
|-------------------------|----|--------|--------|
| 37                      | 44 | 7      | AERIAL |
| SCALE 1:200             |    | NOI314 |        |
| DRAWN BY GRICE 11-16-73 |    |        |        |
| UPDATED                 |    |        |        |