

**Palm Beach County (County) makes no representation or warranties whatsoever on the attached / enclosed information reflected herein pertaining to easements, rights-of-way, setback lines, reservations, agreements, and other similar matters. The information provided herein should not be relied upon by the requesting party to confirm the existence / non-existence of facts contained herein.**

LEGAL DESCRIPTION SECTIONAL BREAKDOWNS



NOTE: ALL OF SEC. 29 IS IN COUNTY - 00

NOTE:  
NOT TO BE REPRODUCED IN ANY FORM EXCEPT BY EXPRESS WRITTEN CONSENT FROM THE PALM BEACH COUNTY ASSESSOR.  
Information shown herein is compiled from the best available sources and CANNOT be used for surveys or land transfers of any type.

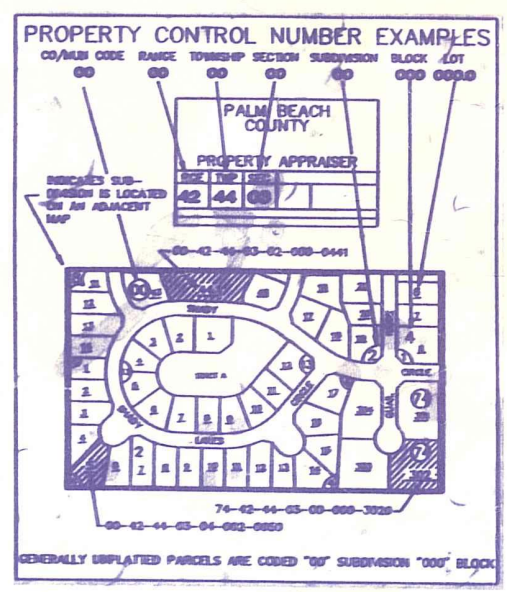

NN-13

**PALM BEACH COUNTY**  
Misc.

PROPERTY APPRAISER

36	31	32	33	34	35	36	31	RGE	TWP	SEC	AERIAL
1	2	3	4	5	6	7	8	37	42	29	NO1213
12	13	14	15	16	17	18	19	SCALE	1"=200'		
15	16	17	18	19	20	21	22	DRAWN BY	GRICE 9-17-73		
24	25	26	27	28	29	30	31	UPDATED			
25	26	27	28	29	30	31	32				
30	31	32	33	34	35	36	31				
1	2	3	4	5	6	7	8				

